



**1°外部特征:(见图纸)**

SCO.01.0005

**Geometry:See drawing**

**2°初始技术特性:(试验前)**

**Primary Technical Properties:(before test)**

电压等级: Tension and limits:		90V/20	150V/20	230V/15	230V/20	350V/20
直流导通电压: DC Spark-over Voltage:	100V/s	72V-108V	120V-180V	195V-265V	184V-276V	280V-420V
冲击导通电压: Impulse Spark-over Voltage:	1kV/μs	≤640V	≤640V	≤700V	≤700V	≤850V
绝缘电阻: Insulation Resistance: 50V DC 100V DC	≤90V ≥90V	≥10GΩ	≥10GΩ	≥10GΩ	≥10GΩ	≥10GΩ
极间电容: Capacitance:	1MHz	≤0.8pF	≤0.8pF	≤0.8pF	≤0.8pF	≤0.8pF
过保护电压: Holdover Voltage:	RC//:150Ω-100nF;RS=330Ω	≥60V	≥75V	≥80V	≥80V	≥80V
辉光降压: Glow Voltage:		≤80V	≤80V	≤100V	≤100V	≤100V
弧光降压: Arc Voltage:		≤25V	≤25V	≤25V	≤25V	≤25V

**3°耐流特性:(试验后满足)**

**Power-flow Properties:(after life test)**

直流导通电压: DC Spark-over Voltage:		72V-108V	120V-180V	195V-265V	184V-276V	280V-420V
冲击导通电压: Impulse Spark-over Voltage:		≤640V	≤640V	≤700V	≤700V	≤850V
绝缘电阻: Insulation Resistance:		≥1000MΩ	≥1000MΩ	≥1000MΩ	≥1000MΩ	≥1000MΩ
交流耐流: AC discharge current: 5times,1s interval 3min	50/60Hz,600V	20A	20A	20A	20A	20A
冲击耐流波形: Impulse discharge current: +5/-5,interval 3min	8/20μs	20KA	20KA	20KA	20KA	20KA
冲击耐流波形: Impulse discharge current:	8/20μs 1time	40kA	40kA	40kA	40kA	40kA
冲击耐流波形: Impulse discharge current:	10/350μs 1time	4KA	4KA	4KA	4KA	4KA
冲击耐流寿命: Impulse life: 300times,interval 2min	10/1000μs	200A	200A	200A	200A	200A

**4°产品编码:**

**Code:**

		9285501	9285502	9285507	9285557	9285515
	UL 497A E184939	YES	YES	YES	YES	YES
	UL 1449 E254293					YES
	REG.-Nr.40008209					

注: 本产品符合2002/95/EC directive(ROHS);所有试验条件均满足ITU-T K.12要求。

Note: This product is 2002/95/EC directive(ROHS);all test are ITU-T K.12 compliant.

总经理 GM	总经理助理 GDTM	销售部 SD	质量部 QD	技术工程部 TD	生产部 PD	日期 Date	编码 N° Code N°
						2009-5-7	92 855 XX XX

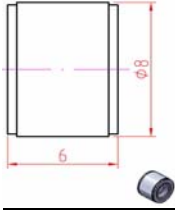

**1°外部特征:(见图纸)**

SCO.01.0005

**Geometry:See drawing**

**2°初始技术特性:(试验前)**

**Primary Technical Properties:(before test)**

电压等级: Tension and limits:		470V/20	500V/20	600V/15	600V/-15+20
直流导通电压: DC Spark-over Voltage:	100V/s	376V-564V	400V-600V	510V-690V	510V-720V
冲击导通电压: Impulse Spark-over Voltage:	1kV/μs	≤1100V	≤1200V	≤1200V	≤1200V
绝缘电阻: Insulation Resistance:	≤90V ≥90V 50V DC 100V DC	≥10GΩ	≥10GΩ	≥10GΩ	≥10GΩ
极间电容: Capacitance:	1MHz	≤0.8pF	≤0.8pF	≤0.8pF	≤0.8pF
过保护电压: Holdover Voltage:	RC//:150Ω- 100nF;RS=330Ω	≥80V	≥80V	≥80V	≥80V
辉光压降: Glow Voltage:		≤120V	≤120V	≤120V	≤120V
弧光压降: Arc Voltage:		≤25V	≤25V	≤25V	≤25V

**3°耐流特性:(试验后满足)**

**Power-flow Properties:(after life test)**

直流导通电压: DC Spark-over Voltage:		376V-564V	400V-600V	510V-690V	510V-720V
冲击导通电压: Impulse Spark-over Voltage:		≤1100V	≤1200V	≤1200V	≤1200V
绝缘电阻: Insulation Resistance:		≥1000MΩ	≥1000MΩ	≥1000MΩ	≥1000MΩ
交流耐流: AC discharge current:	50/60Hz,600V 5times,1s interval 3min	20A	20A	20A	20A
冲击耐流波形: Impulse discharge current:	8/20μs +5/-5,interval 3min	20KA	20KA	20KA	20KA
冲击耐流波形: Impulse discharge current:	8/20μs 1time	40kA	40kA	40kA	40kA
冲击耐流波形: Impulse discharge current:	10/350μs 1time	4KA	4KA	4KA	4KA
冲击耐流寿命: Impulse life:	10/1000μs 300times,interval 2min	200A	200A	200A	200A

**4°产品编码:**

**Code:**

		9285521	9285522	9285576	9285526
UL 497A	E184939	YES	YES	YES	YES
UL 1449	E254293	YES	YES	YES	YES
REG.-Nr.40008209					

注: 本产品符合2002/95/EC directive(ROHS);所有试验条件均满足ITU-T K.12要求。

Note:This product is 2002/95/EC directive(ROHS);all test are ITU-T K.12 compliant.

总经理 GM	总经理助理 GDTM	销售部 SD	质量部 QD	技术工程部 TD	生产部 PD	日期 Date	编码 N° Code N°
						2009-5-7	92 855 XX XX