

**1°外部特征:(见图纸)**

**Geometry:See drawing**

SCO.01.0005

**2°初始技术特性:(试验前)**

**Primary Technical Properties:(before test)**

电压等级: Tension and limits:		65V-95V	90V/20	150V/20	207V-230V	230V/15
直流导通电压: DC Spark-over Voltage:	100V/s	65V-95V	72V-108V	120V-180V	207V-230V	195V-265V
冲击导通电压: Impulse Spark-over Voltage:	1kV/μs	≤640V	≤640V	≤640V	≤700V	≤700V
绝缘电阻: Insulation Resistance:	≤90V ≥90V 50V DC 100V DC	≥10GΩ	≥10GΩ	≥10GΩ	≥10GΩ	≥10GΩ
极间电容: Capacitance:	1MHz	≤0.8pF	≤0.8pF	≤0.8pF	≤0.8pF	≤0.8pF
过保护电压: Holdover Voltage:	RC//:150Ω- 100nF;RS=330Ω	≥60V	≥60V	≥75V	≥80V	≥80V
辉光压降: Glow Voltage:		≤80V	≤80V	≤80V	≤100V	≤100V
弧光压降: Arc Voltage:		≤25V	≤25V	≤25V	≤25V	≤25V

**3°耐流特性:(试验后满足)**

**Power-flow Properties:(after life test)**

直流导通电压: DC Spark-over Voltage:		65V-95V	72V-108V	120V-180V	207V-230V	195V-265V
冲击导通电压: Impulse Spark-over Voltage:		≤640V	≤640V	≤640V	≤700V	≤700V
绝缘电阻: Insulation Resistance:		≥1000MΩ	≥1000MΩ	≥1000MΩ	≥1000MΩ	≥1000MΩ
交流耐流: AC discharge current:	50/60Hz,600V 5times,1s interval 3min	10A	10A	10A	10A	10A
冲击耐流波形: Impulse discharge current:	8/20μs +5/-5,interval 3min	10kA	10kA	10kA	10kA	10kA
冲击耐流波形: Impulse discharge current:	8/20μs 1time	25kA	25kA	25kA	25kA	25kA
冲击耐流波形: Impulse discharge current:	10/350μs 1time	2KA	2KA	2KA	2KA	2KA
冲击耐流寿命: Impulse life:	10/1000μs 300times,interval 2min	100A	100A	100A	100A	100A

**4°产品编码:**

**Code:**

	9280049	9280001	9280002	9280012	9280007
QVGQ2.E184939	YES	YES	YES	YES	YES
REG.-Nr.40008209					

注:本产品符合2002/95/EC directive(ROHS);所有试验条件均满足ITU-T K.12要求。

Note:This product is 2002/95/EC directive(ROHS);all test are ITU-T K.12 compliant.

总经理 GM	总经理助理 GDTM	销售部 SD	质量部 QD	技术工程部 TD	生产部 PD	日期 Date	编码 N° Code N°
						2009-5-7	92 800 XX XX

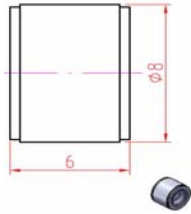

**1°外部特征:(见图纸)**

SCO.01.0005

**Geometry:See drawing**

**2°初始技术特性:(试验前)**

**Primary Technical Properties:(before test)**

电压等级: Tension and limits:		230V/20	240V/15	250V/12	250V/20	260V/20
直流导通电压: DC Spark-over Voltage:	100V/s	184V-276V	204V-276V	220V-280V	200V-300V	208V-312V
冲击导通电压: Impulse Spark-over Voltage:	1kV/μs	≤700V	≤700V	≤750V	≤750V	≤750V
绝缘电阻: Insulation Resistance:	≤90V ≥90V 50V DC 100V DC	≥10GΩ	≥10GΩ	≥10GΩ	≥10GΩ	≥10GΩ
极间电容: Capacitance:	1MHz	≤0.8pF	≤0.8pF	≤0.8pF	≤0.8pF	≤0.8pF
过保护电压: Holdover Voltage:	RC//:150Ω- 100nF;RS=330Ω	≥80V	≥80V	≥80V	≥80V	≥80V
辉光压降: Glow Voltage:		≤100V	≤100V	≤100V	≤100V	≤100V
弧光压降: Arc Voltage:		≤25V	≤25V	≤25V	≤25V	≤25V

**3°耐流特性:(试验后满足)**

**Power-flow Properties:(after life test)**

直流导通电压: DC Spark-over Voltage:		184V-276V	204V-276V	220V-280V	200V-300V	208V-312V
冲击导通电压: Impulse Spark-over Voltage:		≤700V	≤700V	≤750V	≤750V	≤750V
绝缘电阻: Insulation Resistance:		≥1000MΩ	≥1000MΩ	≥1000MΩ	≥1000MΩ	≥1000MΩ
交流耐流: AC discharge current:	50/60Hz,600V 5times,1s interval 3min	10A	10A	10A	10A	10A
冲击耐流波形: Impulse discharge current:	8/20μs +5/-5,interval 3min	10kA	10kA	10kA	10kA	10kA
冲击耐流波形: Impulse discharge current:	8/20μs 1time	25kA	25kA	25kA	25kA	25kA
冲击耐流波形: Impulse discharge current:	10/350μs 1time	2KA	2KA	2KA	2KA	2KA
冲击耐流寿命: Impulse life:	10/1000μs 300times,interval 2min	100A	100A	100A	100A	100A

**4°产品编码:**

**Code:**

9280057 9280008 9280009 9280059 9280010



QVGQ2.E184939

YES YES YES YES YES



REG.-Nr.40008209

注:本产品符合2002/95/EC directive(ROHS);所有试验条件均满足ITU-T K.12要求。

Note:This product is 2002/95/EC directive(ROHS);all test are ITU-T K.12 compliant.

总经理 GM	总经理助理 GDTM	销售部 SD	质量部 QD	技术工程部 TD	生产部 PD	日期 Date	编码 N° Code N°
						2009-5-7	92 800 XX XX





**1°外部特征:(见图纸)**

SCO.01.0005

**Geometry:See drawing**

**2°初始技术特性:(试验前)**

**Primary Technical Properties:(before test)**

电压等级: Tension and limits:		<b>600V/15</b>
直流导通电压: DC Spark-over Voltage:	100V/s	510V-690V
冲击导通电压: Impulse Spark-over Voltage:	1kV/μs	≤1200V
绝缘电阻: Insulation Resistance:	≤90V ≥90V 50V DC 100V DC	≥10GΩ
极间电容: Capacitance:	1MHz	≤0.8pF
过保护电压: Holdover Voltage:	RC//:150Ω- 100nF;RS=330Ω	≥80V
辉光压降: Glow Voltage:		≤120V
弧光压降: Arc Voltage:		≤25V

**3°耐流特性:(试验后满足)**

**Power-flow Properties:(after life test)**

直流导通电压: DC Spark-over Voltage:		510V-690V
冲击导通电压: Impulse Spark-over Voltage:		≤1200V
绝缘电阻: Insulation Resistance:		≥1000MΩ
交流耐流: AC discharge current:	50/60Hz,600V 5times,1s interval 3min	10A
冲击耐流波形: Impulse discharge current:	8/20μs +5/-5,interval 3min	10kA
冲击耐流波形: Impulse discharge current:	8/20μs 1time	25kA
冲击耐流波形: Impulse discharge current:	10/350μs 1time	2KA
冲击耐流寿命: Impulse life:	10/1000μs 300times,interval 2min	100A

**4°产品编码:**

**Code:** 9280076



QVGQ2.E184939



REG.-Nr.40008209

注:本产品符合2002/95/EC directive(ROHS);所有试验条件均满足ITU-T K.12要求。

Note:This product is 2002/95/EC directive(ROHS);all test are ITU-T K.12 compliant.

总经理 GM	总经理助理 GDTM	销售部 SD	质量部 QD	技术工程部 TD	生产部 PD	日期 Date	编码 N° Code N°
						2009-5-7	92 800 XX XX